

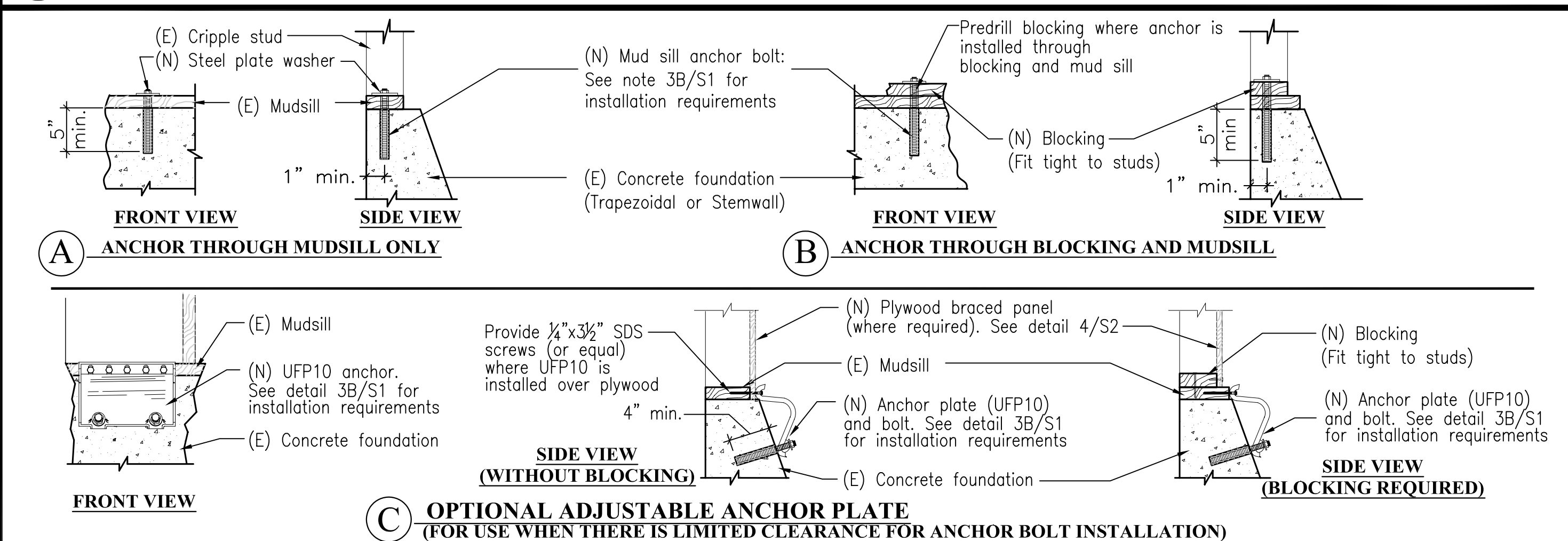

1 FOUNDATION PLAN
CHECK SCALE: ONE SQUARE (1/4") = ONE FOOT

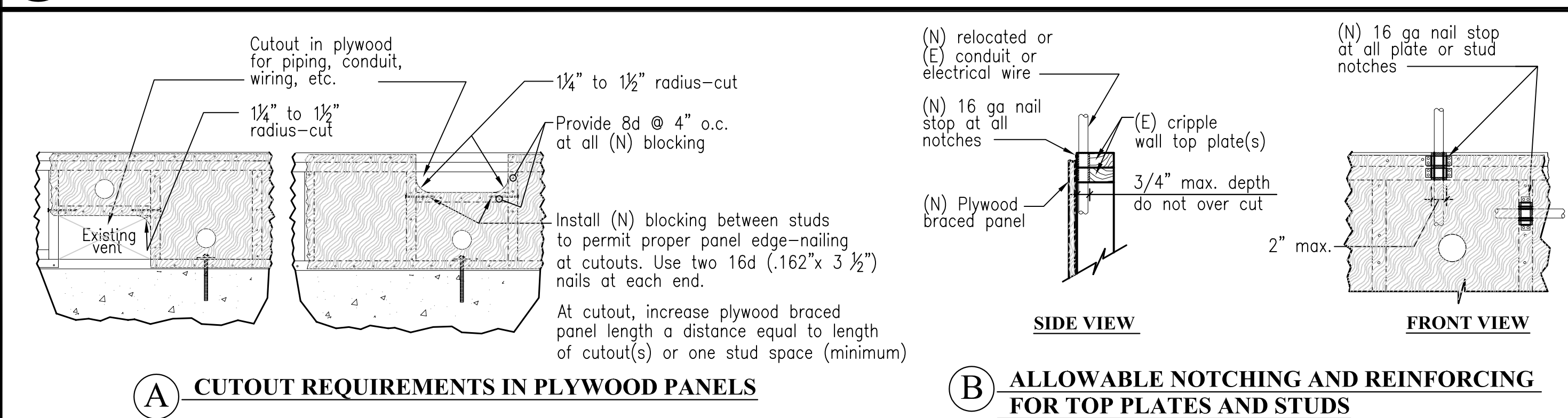

2 TYPICAL MUDSILL TO CONCRETE FOUNDATION CONNECTIONS
SCALE: NTS



3 TYPICAL PANEL CUTOUTS & NOTCHING REQUIREMENTS
SCALE: NTS

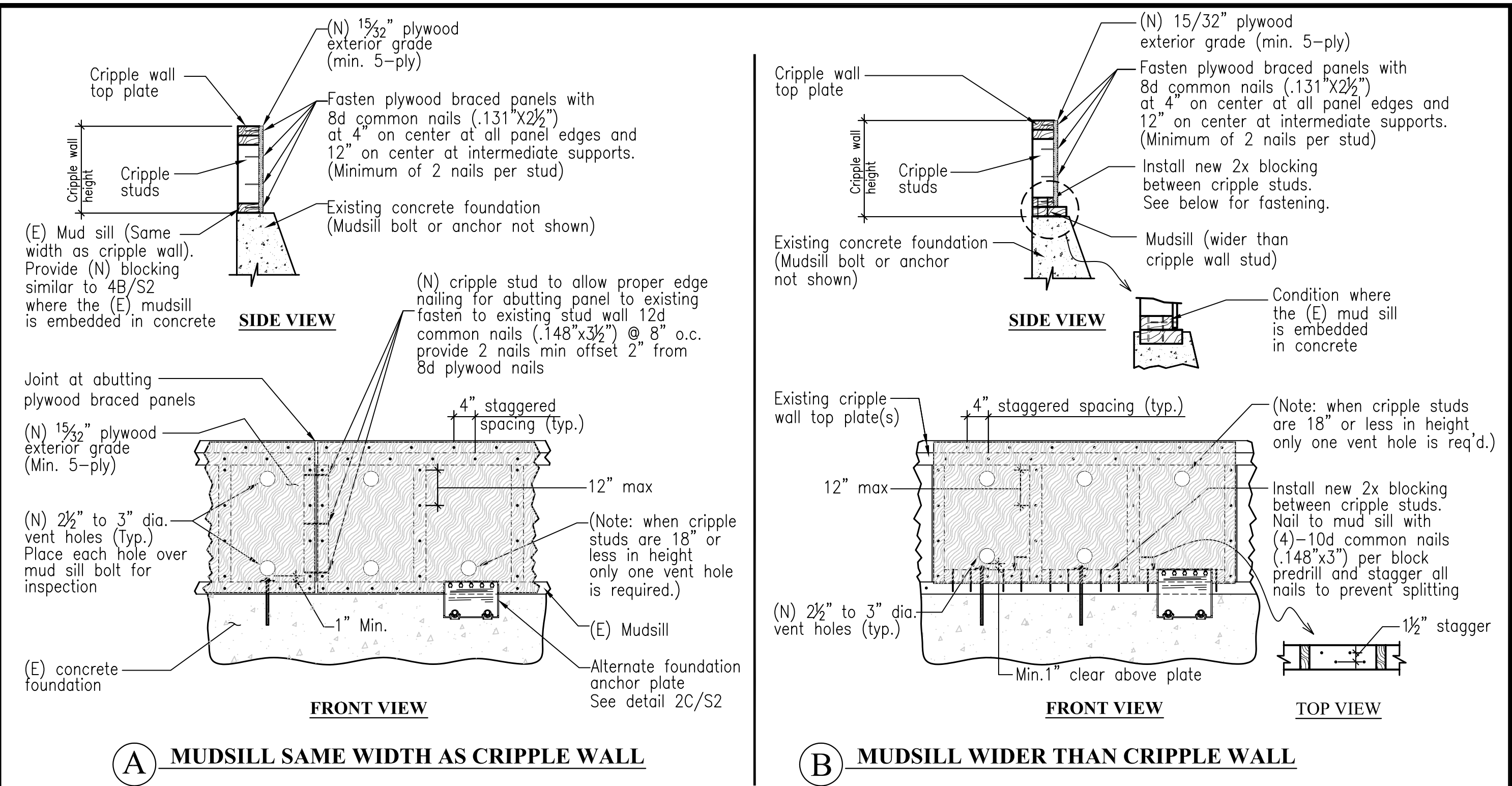

4 PLYWOOD BRACED PANEL INSTALLATION DETAIL
SCALE: NTS

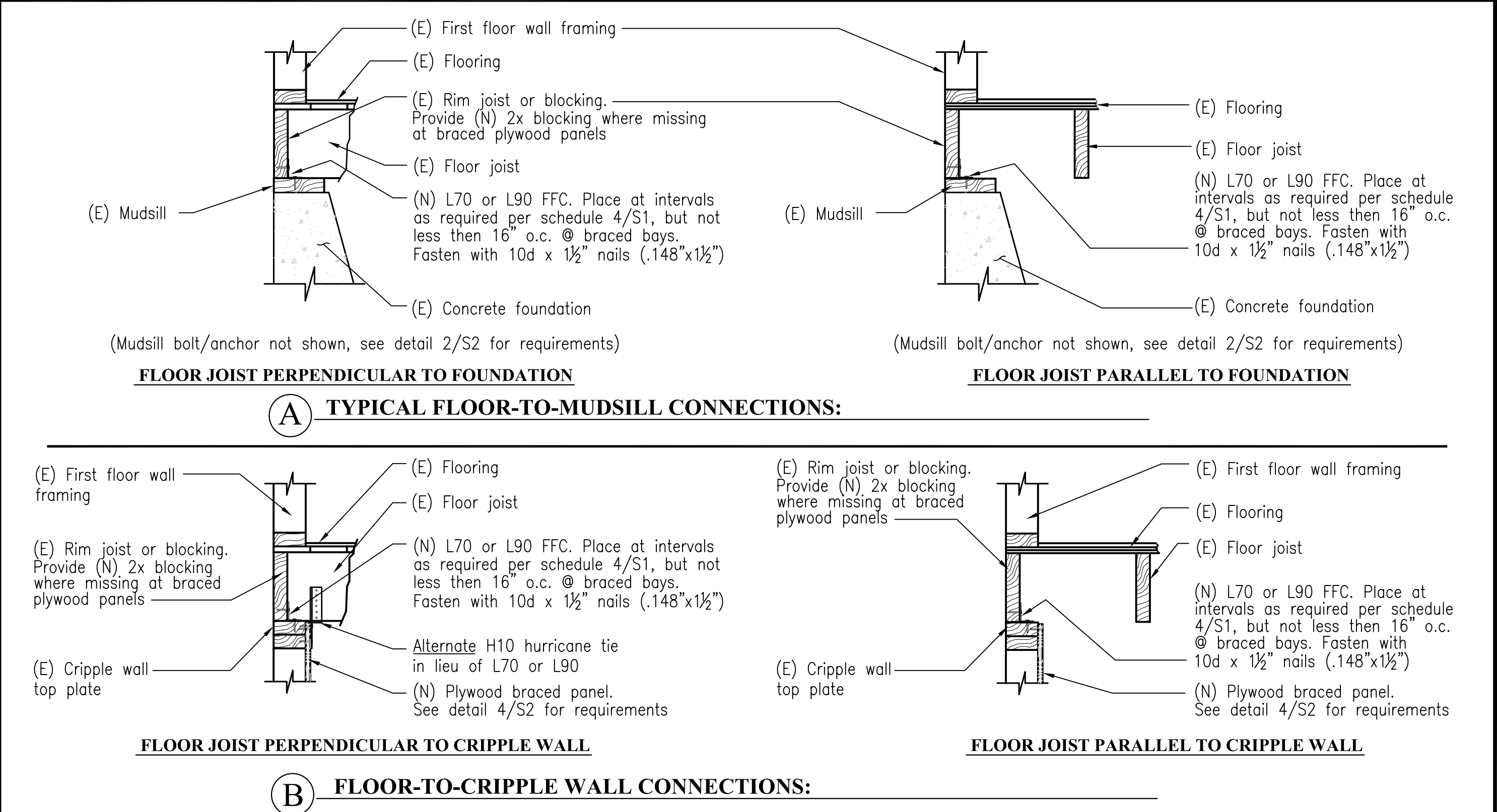

5 TYPICAL FLOOR-TO-CRIPPLE WALL OR FLOOR-TO-MUDSILL CONNECTIONS
SCALE: NTS

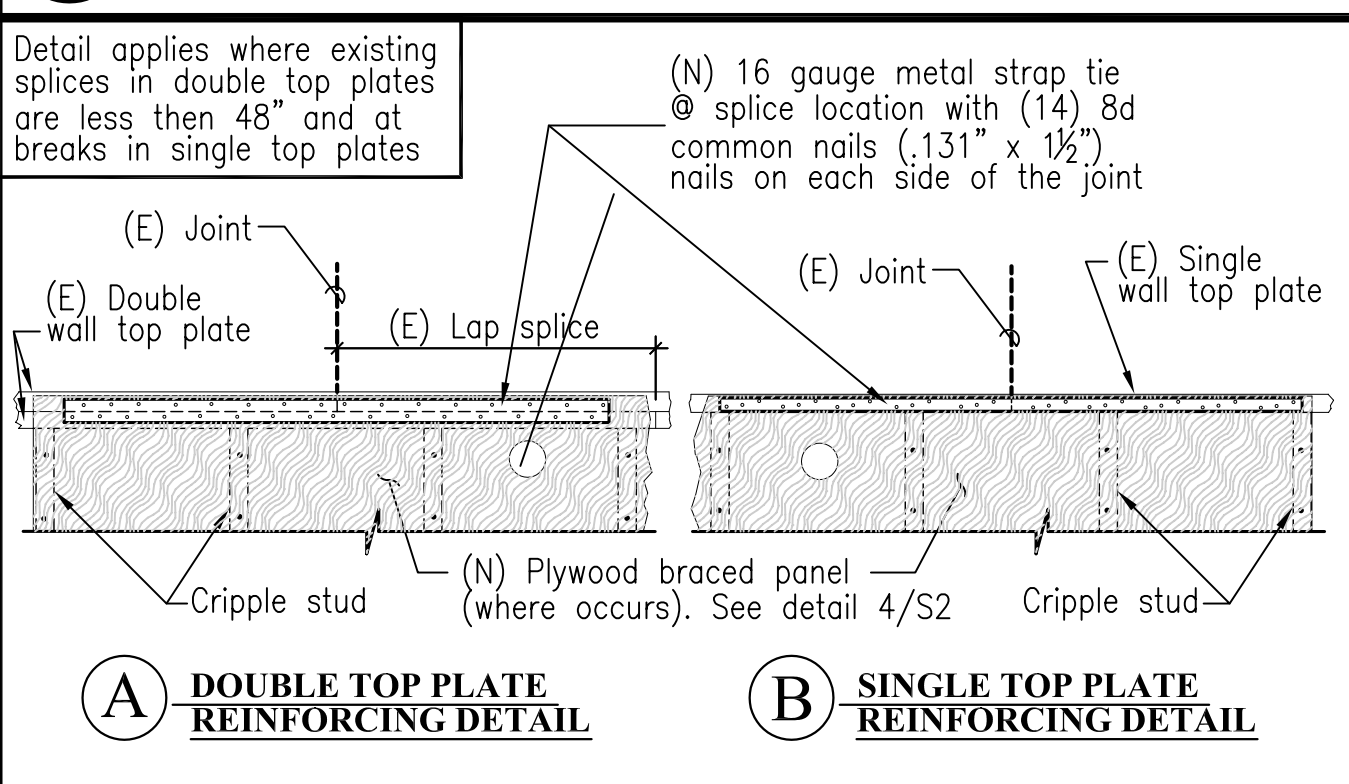

6 TYPICAL TOP PLATE SPLICE DETAILS
SCALE: NTS

ACKNOWLEDGMENTS

This prescriptive plan set and the provisions for voluntary seismic retrofit of wood-frame homes were developed by a committee representing the East Bay and Peninsula chapters of the international code council (ICC). In addition, the plan development committee consisted of representatives from the following organizations who provided contributions and peer review:

- Association of bay area governments (ABAG) earthquake program.
- Building contractors specializing in home retrofitting.
- California building officials (CALBO) emergency preparedness committee.
- California building officials (CALBO) seismic safety committee.
- Earthquake engineering research institute, Northern California chapter (EERI-NC)
- ICC, TRI-chapter (East Bay, Peninsula, Monterey Bay) plan check standards committee.
- Seismology & Structural standards, Light-Frame subcommittee, Existing building committee, Structural engineers association of Northern California (SEAONC)

NOTE - The professional organizations, governmental agencies and others involved in this process, including ICC and its chapters, SEAONC, CALBO, EERI-NC, their committees, and their individual members do not make any warranty or assume any legal liability or responsibility for the use of or reference to opinions, findings, conclusions or recommendations included in these drawings, plan sets, or booklets.

NOTE - Technical changes may not be made without the express permission of the committee.

APPLICANT INFORMATION

APPLICANT: _____

ADDRESS: _____

TELEPHONE: _____

PROPERTY ADDRESS: _____

OWNER: _____

APPLICANT'S SIGNATURE _____

STANDARD PLAN A(2013)

RESIDENTIAL SEISMIC STRENGTHENING PLAN

PRESCRIPTIVE SEISMIC STRENGTHENING PLAN FOR CRIPPLE WALL BRACING AND FOUNDATION SILL PLATE ANCHORAGE OF LIGHT WOOD FRAMED RESIDENTIAL STRUCTURES.

S2

2 OF 2